



Safety Data Sheet

SECTION 1. IDENTIFICATION

GHS Product Identifier:	¾" Stemming Stone
Other Means of Identification:	Aggregate, Crushed Gravel, Granular Material, Crushed Stone
Recommended Use:	Construction, ready-mix concrete, concrete products
Restrictions On Use:	N/A
Canadian Supplier Identifier+:	Fisher Wavy Inc. P.O Box 3000 Copper Cliff, ON P0M 1N0
Emergency Phone Number:	(705) 674-4291

SECTION 2: HAZARD IDENTIFICATION

GHS Classification and Category:	Acute Toxicity- oral, dermal, inhalation (Category 4). Skin Corrosion/Irritation- skin irritation (Category 2). Serious Eye Damage/Eye Irritation-eye irritation- (Category 2 and 2A). Carcinogenicity (Category 1, 1A, 1B, and 2). Specific Target Organ Toxicity- repeated exposure (Category 1 and 2). Respiratory or Skin Sensitization-respiratory sensitizer (Category 1, 1A, and 1B).
---	---

GHS Label Elements
Hazard Pictograms:



Signal Word:	Danger
Hazard Statement:	May cause cancer. May cause damage to organs (lung) through prolonged or repeated exposure. Causes skin irritation. Causes serious eye irritation. Harmful if swallowed.
Precautionary Statement(s) General:	Obtain special instructions before use. Do not handle until all safety precautions have been read and understood.
Prevention:	Do not breathe dust. Wash any exposed body parts. Wear protective gloves/protective clothing/eye protection/face protection. Do not swallow.
Response:	If exposed or concerned: Get medical advice/attention. Use respiratory protection. If on skin: Wash with plenty of water. Take off contaminated clothing and wash it before reuse. If in eyes: Rinse continuously with water for several minutes. If swallowed: Call a poison center/doctor if you feel unwell. Rinse mouth.
Storage:	Restrict and control access to stockpile areas. Engulfment hazard: To prevent burial or suffocation, do not enter a confined space without an effective procedure for assuring safety.
Disposal:	Dispose of contents/container in accordance with local/regional/national/international regulations.
Hazards Not Otherwise Classified (HNOC):	Respirable Crystalline Silica (RCS) may cause cancer. Crushed aggregate is a naturally occurring mineral complex that contains varying quantities of quartz (crystalline silica). In its natural bulk state, crushed aggregate is not a known health hazard. Crushed aggregate may be subjected to various natural and mechanical forces that produce small particles (dust) which may contain respirable crystalline silica (particles less than 10 micrometers in aerodynamic diameter). Repeated inhalation of respirable crystalline silica may cause lung cancer according to IARC and NTP; ACGIH states that it's a suspected cause of cancer.

SECTION 3. COMPOSITION/INFORMATION ON INGREDIENTS

Chemical name: Crushed Stone

Chemical Abstract Service (CAS) registry number and unique identifiers:

Component	Percentage (%)	CAS Number
Metamorphic Rock	99-100	N/A
Quartz (Crystalline silica)	>1	14808-60-7
Mica	>1	12001-26-2

Component Information on Non-Hazardous Components:

Trace elements: These materials are mined from the earth. Trace amounts of naturally occurring elements might be detected during chemical analysis of these materials.

SECTION 4. FIRST AID MEASURES

First Aid

Eye contact: Immediately flush eyes thoroughly with running water. Call physician if irritation persists.

Skin contact: Wash with soap and water. Call physician if irritation persists.

Ingestion: Do not induce vomiting. If conscious, rinse mouth with water. Seek medical attention if any problems arise.

Inhalation: Remove to fresh air. Obtain medical attention if breathing difficulties persist.

Most important symptoms and effects (acute or delayed)

General: Causes damage to organs through prolonged or repeated exposure.

Inhalation: Repeated exposure to respirable (airborne) crystalline silica dust will cause lung damage in the form of silicosis.

Skin contact:	Repeated or prolonged skin contact may cause skin irritation.
Eye contact:	Repeated or prolonged contact will cause mechanical irritation.
Ingestion:	Ingestion is likely to be harmful or have adverse effects.
Chronic Symptoms:	Causes damage to organs through prolonged or repeated exposure. Repeated or prolonged exposure to respirable (airborne) crystalline silica dust will cause lung damage in the form of silicosis. Symptoms will include progressively more difficult breathing, cough, fever, and weight loss.
Immediate medical attention and special treatment, if necessary:	If you feel unwell, seek medical advice (show the label where possible).

SECTION 5. FIRE-FIGHTING MEASURES

Suitable extinguishing media:	No fire hazard present for this material.
Unsuitable extinguishing media:	No fire hazard present for this material.
Specific hazards arising from hazardous product:	Not flammable. Not explosive. Not reactive under normal conditions.
Special protective equipment and precautions for fire-fighters:	No fire hazard present for this material.

SECTION 6. ACCIDENTAL RELEASE MEASURES

<i>Personal precautions, protective equipment, and emergency procedures</i>	
For non-emergency personnel:	Use appropriate personal protective equipment and evacuate unnecessary personnel.
For emergency personnel:	Equip clean-up crew with proper protection and ventilate area.

Environmental precautions:	N/A
Methods and material for containment and clean up	
Containment:	Contain and collect as any solid.

SECTION 7. HANDLING AND STORAGE

Precautions for safe handling:	Handle in accordance with good industrial hygiene and safety procedures. Wash hands and other exposed areas with mild soap and water before eating, drinking, or smoking and when leaving work.
<i>Conditions for safe storage (including incompatible materials)</i>	
Technical measures:	Comply with applicable regulations.
Storage conditions:	Keep/store away from incompatible materials.
Incompatible materials:	Strong acids, strong bases, strong oxidizers.

SECTION 8. EXPOSURE CONTROLS/PERSONAL PROTECTION

<i>Control parameters</i>	
Component exposure limits:	Respirable Silica Dust- 0.2mg/m ³ TWAEV (Time-Weighted Average Exposure Values) Quartz (14808-60-7); ACGHI: 0.025 mg/m ³ TWA (respirable fraction) NIOSH: 0.025 mg/m ³ TWA (respirable dust)
Appropriate engineering controls:	Ensure adequate ventilation, especially in confined areas. Clean water should always be readily available for skin and (emergency) eye washing. Ensure all national/local regulations are observed.
Personal Protective Equipment (PPE):	Protective goggles or safety glasses with side shields. Gloves. Protective clothing. Dust formation: dust mask.

Fisher Wavy Inc.
 Safety Data Sheet: ¾” Stemming Stone
 According to GHS 2015 Rules and Regulations

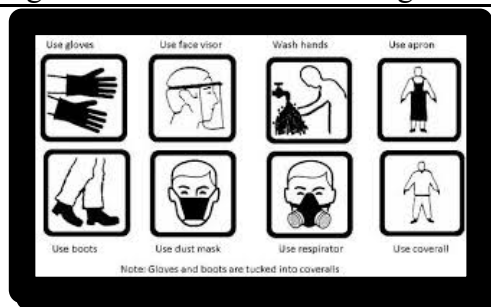

SECTION 9. PHYSICAL AND CHEMICAL DATA

Appearance (Physical state, colour etc.):	Solid, Gray, Solid mixture, Particles of varying size
Odour:	N/A
Odour threshold:	N/A
pH:	N/A
Melting point/freezing point:	N/A
Initial boiling point/boiling range:	N/A
Flash point:	N/A
Evaporation rate:	N/A
Flammability (solid; gas):	N/A
Lower flammable/explosive limit:	N/A
Upper flammable/explosive limit:	N/A
Vapour pressure:	N/A
Vapour density:	N/A
Relative density:	N/A
Solubility:	Insoluble in water.
Partition coefficient-n-octanol/water:	N/A
Auto-ignition temperature:	N/A
Specific Gravity:	2.65-2.97
Viscosity:	N/A

SECTION 10. STABILITY AND REACTIVITY

Reactivity:	Hazardous reactions will not occur under normal conditions.
Chemical stability:	Stable under recommended handling and storage conditions.
Possibility of hazardous reactions:	Hazardous polymerization will not occur.
Incompatible materials:	Strong acids, strong bases, strong oxides.
Hazardous decomposition products:	Quartz (silica) will dissolve in hydrofluoric acid producing a corrosive gas, silicon tetrafluoride.

SECTION 11. TOXICOLOGICAL INFORMATION

Information on

Toxicological Effects- Product

Acute toxicity:	Not classified
Skin corrosion/irritation:	Not classified
Serious eye Damage/Irritation:	Not classified
Respiratory or Skin Sensitization:	Not classified
Carcinogenicity:	Not classified
Specific target organ toxicity (repeated exposure):	Causes damage to organs through repeated or prolonged exposure.
Specific target organ toxicity (single exposure):	Not classified
Symptoms/Injuries after inhalation:	Repeated exposure to respirable (airborne) crystalline silica dust will cause lung damage in the form of silicosis.
Symptoms/Injuries after skin contact:	Repeated or prolonged skin contact may cause irritation.
Symptoms/Injuries after eye contact:	Repeated and prolonged contact will cause mechanical irritation.

Symptoms/Injuries after ingestion:	Ingestion is likely to be harmful or have adverse effects.																
Chronic symptoms:	Causes damage to organs through prolonged or repeated exposure. Repeated or prolonged exposure to respirable (airborne) crystalline silica dust will cause lung damage in the form of silicosis. Symptoms will include progressively more difficult breathing, cough, fever, and weight loss.																
Information on toxicological effects- Ingredients LD50 and LC50 data:	<table border="1"> <tr> <td colspan="2">Quartz (14808-60-7)</td> </tr> <tr> <td>LD50 Oral rat</td> <td>>5000mg/kg</td> </tr> <tr> <td>LD50 Dermal rat</td> <td>>5000 mg/kg</td> </tr> <tr> <td colspan="2">Quartz (14808-60-7)</td> </tr> <tr> <td>IARC Group</td> <td>1</td> </tr> <tr> <td>National Toxicology Program (NTP) status</td> <td>Known Human Carcinogens</td> </tr> <tr> <td>OSHA hazard Communication</td> <td>In OSHA Hazard Communication</td> </tr> <tr> <td>Carcinogen List</td> <td>Carcinogen list</td> </tr> </table>	Quartz (14808-60-7)		LD50 Oral rat	>5000mg/kg	LD50 Dermal rat	>5000 mg/kg	Quartz (14808-60-7)		IARC Group	1	National Toxicology Program (NTP) status	Known Human Carcinogens	OSHA hazard Communication	In OSHA Hazard Communication	Carcinogen List	Carcinogen list
Quartz (14808-60-7)																	
LD50 Oral rat	>5000mg/kg																
LD50 Dermal rat	>5000 mg/kg																
Quartz (14808-60-7)																	
IARC Group	1																
National Toxicology Program (NTP) status	Known Human Carcinogens																
OSHA hazard Communication	In OSHA Hazard Communication																
Carcinogen List	Carcinogen list																

SECTION 12. ECOLOGICAL INFORMATION
(information is optional)

Ecotoxicity:	No additional information available
Persistence and degradability:	N/A
Bioaccumulative potential:	N/A
Mobility in soil:	N/A
Other adverse effects:	Avoid release to the environment.

SECTION 13. DISPOSAL CONSIDERATIONS
(information is optional)

<i>Waste Disposal</i>	
Recommendations:	Dispose of waste material in accordance with all local/regional/national/provincial/territorial/and international regulations.
Ecology- Waste Materials:	Avoid release to the environment.

SECTION 14. TRANSPORT INFORMATION

(information is optional)

UN number:	N/A
UN proper shipping name:	N/A
Transport hazard class(es):	N/A
Packing group:	N/A
Environmental hazards:	N/A
Transport in bulk, if applicable:	Follow MTO regulations
Special precautions:	Dry fine materials best transported by bulk tanker or sealed bags. Aggregate should be sheeted or conditioned with water to minimize dust.

SECTION 15. REGULATORY INFORMATION

(information is optional)

Canadian Regulations

Crushed Stone

WHMIS classification: Class D Division 2 Subdivision A- Very toxic material causing other toxic effects



Quartz (14808-60-7) Listed on the Canadian DSL (Domestic Substance List)
Listed on the Canadian IDL (Ingredient Disclosure List)

IDL Concentration: 1%

WHMIS Classification: Class D Division 2 Subdivision A- Very toxic material causing other toxic effects
Class D Division 2 Subdivision B- Toxic material causing other toxic effects

SECTION 16. OTHER INFORMATION

Hazardous Material Information

System (HMIS):

Health: 1

Flammability: 0

Physical Hazard: 0

Personal Protection: A

NFPA/HMIS definitions:

0-least, 1-slight, 2-moderate, 3-high, 4-extreme
Protective Equipment: safety glasses, gloves

Revision date:

November 10, 2016

Other Information:

This document has been prepared in accordance with the SDS requirements of the OSHA Hazard Communication Standard 29 CFR 1910.1200.

“The information provided herein is believed by seller to be accurate at the time of preparation, or prepared from sources believed to be reliable. Health and Safety precautions in this data sheet may not be adequate for all individuals or situations. Users have the responsibility to comply with all laws and procedures applicable to the safe handling and use of the product, to determine the suitability of the product for its intended use, and to understand possible hazards associated with mixing this product with other materials. SELLER MAKES NOWARRANTY, EXPRESS OR IMPLIED, CONCERNING THE PRODUCT, THE MERCHANTABILITY, OR FITNESS THEROF FOR ANY PURPOSE, CONCERNING THE ACCURACY OF ANY INFORMATION PROVIDED BY SELLER.”